

ELEVATION

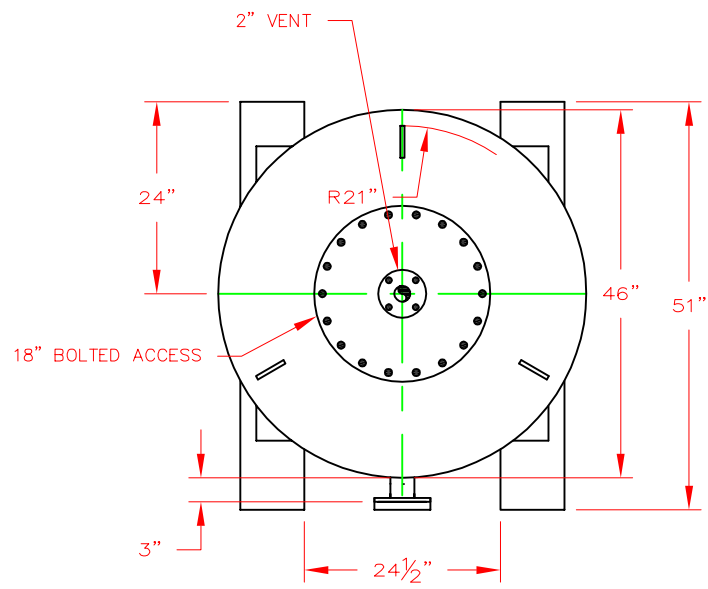

PLAN

VESSEL STANDARDS

VESEL MATERIALS : CARBON STEEL	LIQUID DRAIN ASSEMBLY : SCHEDULE 80 PVC
LINING : POLYETHYLENE	VOLUME OF VESSEL : 62 FT. ³ NOT INCLUDING TOP HEAD
EXTERIOR PAINT : ACRYLIC ALKYD ENAMEL	STANDARD/MAX CARBON FILL : 1000 LBS / 1600 LBS
HEAD THICKNESS : 3/16"	SHIP WT. OPERATING WT.STD.FILL : 2040 LBS / 5800 LBS
SHELL THICKNESS : 3/16"	CARBON TYPE : TIGG 5D 1240 LIQUID PHASE
INTERNALS : SCHEDULE 40 PVC	MAX. OPERATING PRESSURE : 30 PSIG
ADSORBENT OUTLET ASSEMBLY : SCHEDULE 80 PVC	MAX. OPERATING TEMP. : 115°F

3	CHANGE EXTERIOR PAINT	JB	1/21/03
2	REVISE HEIGHT	JB	12/19/02
1	REVISE TITLE BLOCK	JB	9/3/02
NO.	REVISION	BY	DATE

PROJECT

STANDARD

PROJ. NO. SALES
P.O. NO.

THIS DRAWING AND DESIGN ARE THE PROPERTY OF TIGG CORP. AND SHALL NOT BE REPRODUCED IN WHOLE OR IN PART AND NOT EMPLOYED FOR ANY PURPOSES OTHER THAN SPECIFICALLY PERMITTED IN WRITING BY TIGG CORP. RETURN ON DEMAND.

DRAWN BY ZS
DESIGN BY BL
CHKD. BY BL
DATE 7/31/00
SCALE NTS



C-50-RX

DWG. NO. C-50-RX-1001 REV. 3