

ELEVATION

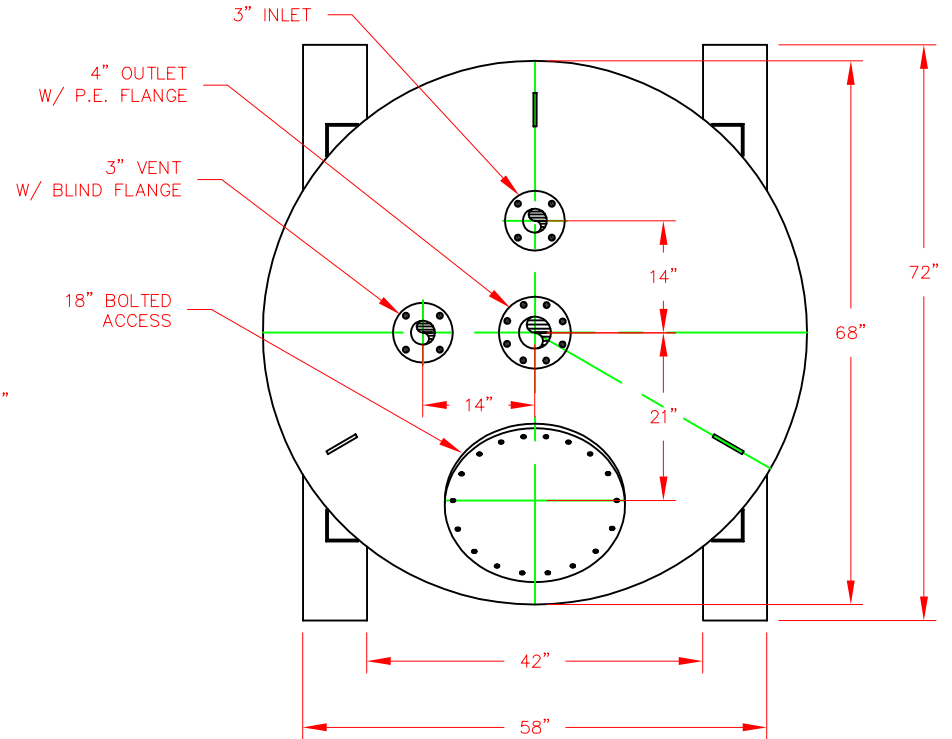

PLAN

VESSEL STANDARDS

VESEL MATERIALS : A36 CARBON STEEL	LIQUID DRAIN ASSEMBLY : SCHEDULE 80 PVC
LINING : POLYETHYLENE	VOLUME OF VESSEL : 140 FT. ³ NOT INCLUDING TOP HEAD
EXTERIOR PAINT : ACRYLIC ALKYD ENAMEL	STANDARD/MAX CARBON FILL : 3000 LBS / 3600 LBS
HEAD THICKNESS : 3/16"	SHIP WT. OPERATING WT.STD.FILL : 4790 LBS / 13100 LBS
SHELL THICKNESS : 3/16"	CARBON TYPE : TIGG 5D 1240 LIQUID PHASE
INTERNALS : SCHEDULE 40 PVC	MAX. OPERATING PRESSURE : 30 PSIG
ADSORBENT OUTLET ASSEMBLY : SCHEDULE 80 PVC	MAX. OPERATING TEMP. : 115°F

3	CHANGE EXTERIOR PAINT	JB	1/21/03
2	REVISE HEIGHT	JB	1/8/03
1	TITLE BLOCK	JB	9/4/02
NO.	REVISION	BY	DATE

PROJECT

STANDARD

PROJ. NO. SALES

P.O. NO.

THIS DRAWING AND DESIGN ARE THE PROPERTY OF TIGG CORP. AND SHALL NOT BE REPRODUCED IN WHOLE OR IN PART, NOR EMPLOYED FOR ANY PURPOSE OTHER THAN SPECIFICALLY PERMITTED IN WRITING BY TIGG CORP. THIS DRAWING IS SUBJECT TO REVISION ON DEMAND.

DRAWN BY ZS

DESIGN BY BL

CHKD. BY BL

DATE 7/31/00

SCALE NTS



C-100-RX

DWG. NO. C-100-RX-1001 REV. 3